



SMART
TECH

SMART Wi-Fi
GARAGE DOOR
CONTROLLER

USER MANUAL

Thank you for purchasing your
Connex Connect Smart Tech device.

Download the **Connex Connect** App
from Google Play or iOS store, and connect
your Smart Tech devices to your home
2.4 GHz Wi-Fi.

One App to manage all
your Smart Tech devices from your
mobile or tablet.

Contents

What's in the Box	4
Requirements	4
Download App	5
Installation Method	6
Register Account	7
Plug In and Connect	8
Connect (Easy Mode)	9
Connect (AP Mode)	10
Specifications	13
FAQ's	14
System Requirements	15
CE Certification	15
Important Information	16
Cleaning & Care Instructions	17
Environmentally Friendly Disposal	17
Support	18
Warranty	19

What's in the Box

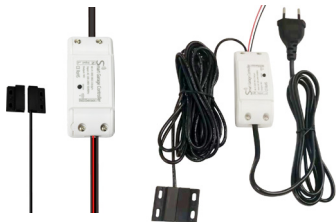

- 1 x Garage Door Controller
- 3 x 3 m Stickers
- 2 x Brackets
- 4 x Cable Ties
- 10 x Screws

Requirements

- Make sure you are connecting to a 2.4 GHz Wi-Fi network.
- **Connex Connect** won't work on a 5 GHz Wi-Fi network.
- Have your Wi-Fi network name and password ready.
- Make sure your mobile device is running iOS® 8 or higher or Android™ 4.1 or higher.

Installation Method

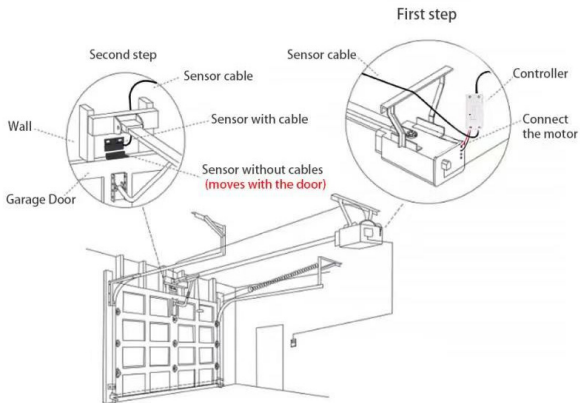

Installation Method (Wall & Garage Door)

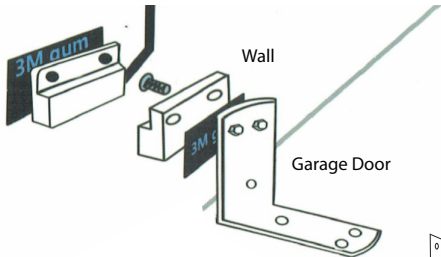

Garage Controller



Line Holders

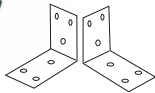

Brackets



3M Stickers



Screws



Ties

It is hard to install with screws, you can also use the 3 metre gums to finish. If you are worried about the steadiness, you can use both screws and 3 metre gums.

Installation Method

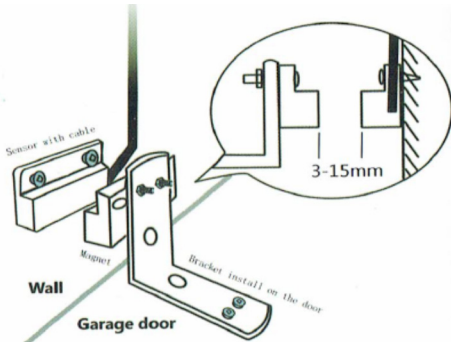

Step 1: Power up

Step 2: Connect to the wall - Insert the red & black wire 2.0 mm terminal to the garage, then put each ?? to the same terminals as the button wires are terminated to.

Step3: Connect to the garage door - Insert the 2.0 mm terminal of the sensor to the garage, then steady install the sensor and the magnet of the gap within 3 mm to 15mm on your garage door with screws / brackets / 3M gums / wall nails / line holders / ties.

Device Test

! Test Device For Opener Compatibility

- 1.Power up the garage device,the red light and blue light flash alternatively.
- 2.Use the included Red & Black wire connect the device to your opener;Put each end to the same terminals as the wall button wires are terminated to.
- 3.Use a tiny screw or nail to click the buto in the device,your garage door should activate.
- 4.Three type power supply mode (default power supply is AC100~250V)
(1) AC100~250V (2) DC5V (3) DC9~36V

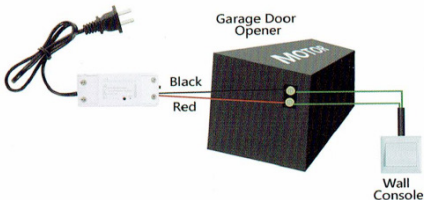

If this test fails,your device may not be compatible.For additional installation instructions and the list of compatible models,please check it from other's User manual and contact us online directly.

Step

1

**Download the Connex Connect App
from Google Play or iOS store.**



**Connex
Connect**



Get the App!



Step

2

Register an Account on the Connex Connect App

← Email Phone

Register by Phone

South Africa +27 >

Mobile

Obtain verification code

← Email Phone

Register by email

South Africa +27 >

Email

Obtain verification code

Log in

South Africa +27 >

Mobile number/e-mail address

Password

Log in

[Verification code login](#) [Forgot password](#)

Step

3

Plug In and Connect

Plug in the Connex Connect Garage Controller and switch on. (The Garage Controller LED will flash repeatedly, 2 x per second: Easy Mode).

How to Reset the Device

- Reset the universal remote by pressing and holding the button for 3 seconds until the indicator light flashes rapidly. You will then be in "Easy Mode", fast blinking light, 2 x per second.
- Reset again by pressing and holding the button for 3 seconds until the indicator light flashes slowly. You will then be in "AP Mode", which is the back-up mode of connection, slowly flashing once every 3 seconds.

Step

4

Easy Mode Connection

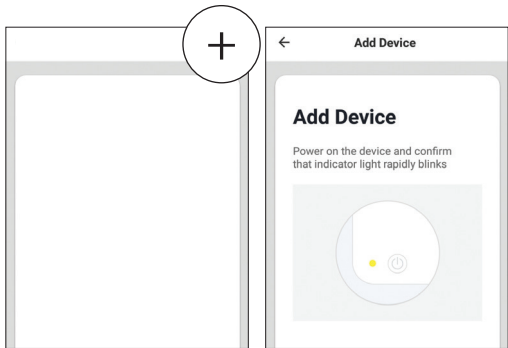

In the **Connex Connect** App top right corner of the device screen, click "+".

Make sure the LED is flashing rapidly indicating "ready to connect".

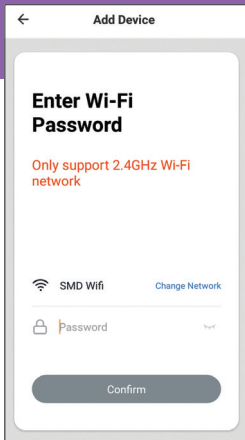

Enter your Wi-Fi network and password.

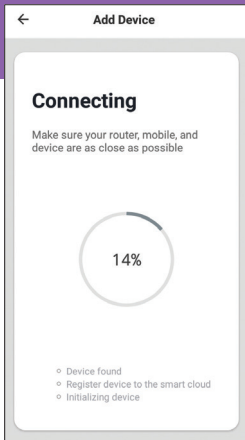

The **Connex Connect** App will connect to your device.

If the connection fails, then try connecting using the AP Mode.

Step

5

AP Mode Connection

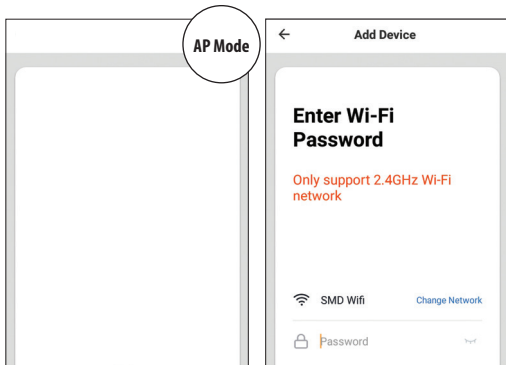

In the **Connex Connect** App top right corner of the device screen, click “+”.

Select “AP Mode” in top corner.

Select “next” and enter your Wi-Fi and password details.

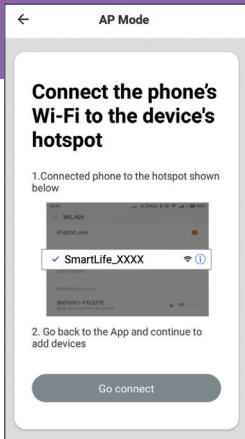

Follow the instructions to choose the device from your Wi-Fi list.

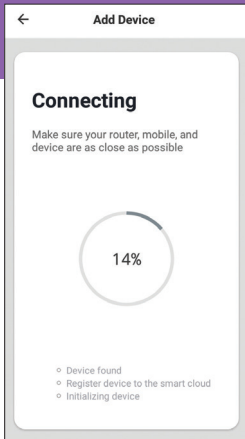

The **Connex Connect** App will connect to your device.

Specifications

- App: Connex Connect
- Technology: Wi-Fi
- Connectivity: Wi-Fi 802.11bgn 2.4 GHz (Wi-Fi 4)
- Voltage In: 220 V / 1 A
- Voice Assistant: Amazon Alexa, Google Assistant

FAQ's

1. How many devices can I control?

Connex Connect App can control unlimited number of devices and locations. Your router has a limit as to how many devices can connect to it.

2. How do I group multiple Connex Connect devices?

You can group multiple similar devices together by room or by location. The same device can form part of multiple groups. From the **Connex Connect** App main screen, select the device you want to group. Select edit in top right corner. Then select "Create Group". You can then select devices which you would like to group and will be able to rename them.

3. How do I share devices with family and friends?

You can share devices by selecting the "Me" icon → Home Management → Add Family. In order to share a family member needs to have downloaded the **Connex Connect** App and registered.

4. What is the wireless range?

The range of your Wi-Fi is dependent on your home router specifications and the strength of your Wi-Fi signal.

5. Why does the universal remote appear off-line?

- Ensure the universal remote is turned ON.
- Make sure your Wi-Fi router is on and in range (your **Connex Connect** Smart device requires a Wi-Fi signal to function correctly).

FAQ's

6. Why can't I connect to my Wi-Fi?

- Ensure your device and your mobile are on the same home network.
- Make sure you entered the correct Wi-Fi password during set-up.
- Ensure your Wi-Fi signal strength extends to your device location.

System Requirements

- Mobile device running iOS® 8 or higher or Android™ 4.1 or higher.
- An existing 2.4 GHz Wi-Fi network.

CE Certification

This device complies with CE Radio Equipment Directive [RED] 2014/53/EU & Restriction of Hazardous RoHS Directive 2011/65/EU. Operation is subject to the following two conditions: (1) This device may not cause harmful interference, and (2) This device must accept any interference received, including interference that may cause undesired operation.

Important Information

Before using the universal remote, please read and follow all instructions, including the following.

CAUTION: Risk of electric shock or burns and use in a dry location only.

Do not install the device with wet hands or when standing on a wet or damp surface. Suitable for use in an operating environment between -20 °C and 40 °C (-4 °F and 104 °F).



Cleaning & Care Instructions

- **Before Cleaning:** Ensure that your **Connex Connect** garage controller is not plugged into any socket before cleaning or maintaining it.
- **Cleaning:** Wipe down the surface of your **Connex Connect** garage controller using a soft, slightly damp cloth.
- Do not use any harsh or abrasive cleaning chemicals or materials on your **Connex Connect** garage controller as doing so may damage or scratch the surface finish.
- Do not expose your **Connex Connect** garage controller to high temperatures for extended periods of time.
- Do not store in temperatures over 60 °C / 140 °F.

Environmentally Friendly Disposal



Do not dispose of electrical appliances as unsorted municipal waste, use separate collection facilities. Contact your local government for information regarding the collection systems available. If electrical appliances are disposed of in landfills or dumps, hazardous substances can leak into the groundwater and get into the food chain, damaging your health and well-being.

Support

Please visit us at www.connexconnect.com for answers to common issues and to see the full selection of products. If you still have any queries contact us at info@connexconnect.com

The illustrated product and specifications may differ slightly from those supplied. Connex is a trademark of SMD Technologies (Pty) Ltd. iPhone, Apple and the Apple logo are trademarks of Apple Inc., registered in the U.S. and other countries. App Store is a service mark of Apple Inc. Android Google Assistant, Google Play, and the Google Play logo are trademarks of Google Inc. Google is a trademark of Google LLC. iOS is a registered trademark of Cisco in the U.S. and other countries and is used under license.

Amazon, Alexa and all related logos are trademarks of Amazon.com, Inc or its affiliates. All other trademarks and trade names are those of their respective owners.

©2021 Connex Connect (Pty) Ltd
23 Nguni Drive, Long Meadow Business Estate West, Modderfontien,
Johannesburg, South Africa, 1609.

Warranty

This **Connex Connect** Smart Wi-Fi Garage Controller includes a standard 12-month limited warranty against manufacturing defects and faults. Should your product be unboxed with any faulty parts, poor finishing or visible damage, or fail to perform due to a manufacturing defect or poor workmanship, please return it with your proof of purchase (till slip or invoice) to the store of purchase for an exchange, or repair, depending on the store's returns policy.

This warranty commences from the date of purchase. Kindly retain your proof of purchase as well as the packaging for your warranty period.

NOTE: The Warranty does not apply to a Product that:

- a) Has failed due to excessive wear and tear beyond what is considered to be reasonable.
- b) Has been misused or neglected.
- c) Has been damaged accidentally or by Force Majeure including fire and flooding.
- d) Has been used or operated contrary to operating or maintenance instructions outlined in this manual.

The Store of Purchase / Seller cannot accept any returned products that have not been returned in accordance to this warranty or which does not follow their own Returns Policy. Please refer to the Store of Purchase / Sellers Returns Policy for details.

Should you require any further assistance or have any questions on your warranty, please contact the store of purchase.



Connex Connect Support:

Visit us at www.connexconnect.com for answers to common issues and to see the full selection of products. If you still have any queries contact us at info@connexconnect.com

SCAN QR CODE

